FENWICK SOLAR FARM

Fenwick Solar Farm
EN010152

Framework Construction Traffic Management Plan

Part 2 of 2

Document Reference: EN010152/APP/7.17

Regulation 5(2)(a)

Infrastructure Planning (Applications: Prescribed Forms and Procedure)
Regulations 2009

December 2024
Revision Number: 01

Revision History

| Revision Number | Date | Details |
|------------------------|---------------|-----------------|
| 00 | October 2024 | DCO application |
| 01 | December 2024 | S51 Response |
| | | |
| | | |
| | | |

Prepared for:
Fenwick Solar Project Limited

Prepared by:
AECOM Limited

© 2024 AECOM Limited. All Rights Reserved.

This document has been prepared by AECOM Limited (“AECOM”) for sole use of our client (the “Client”) in accordance with generally accepted consultancy principles, the budget for fees and the terms of reference agreed between AECOM and the Client. Any information provided by third parties and referred to herein has not been checked or verified by AECOM, unless otherwise expressly stated in the document. No third party may rely upon this document without the prior and express written agreement of AECOM.

Annex A Proposed Access Layouts, Visibility Splays and Swept Paths

Access 6 to 13

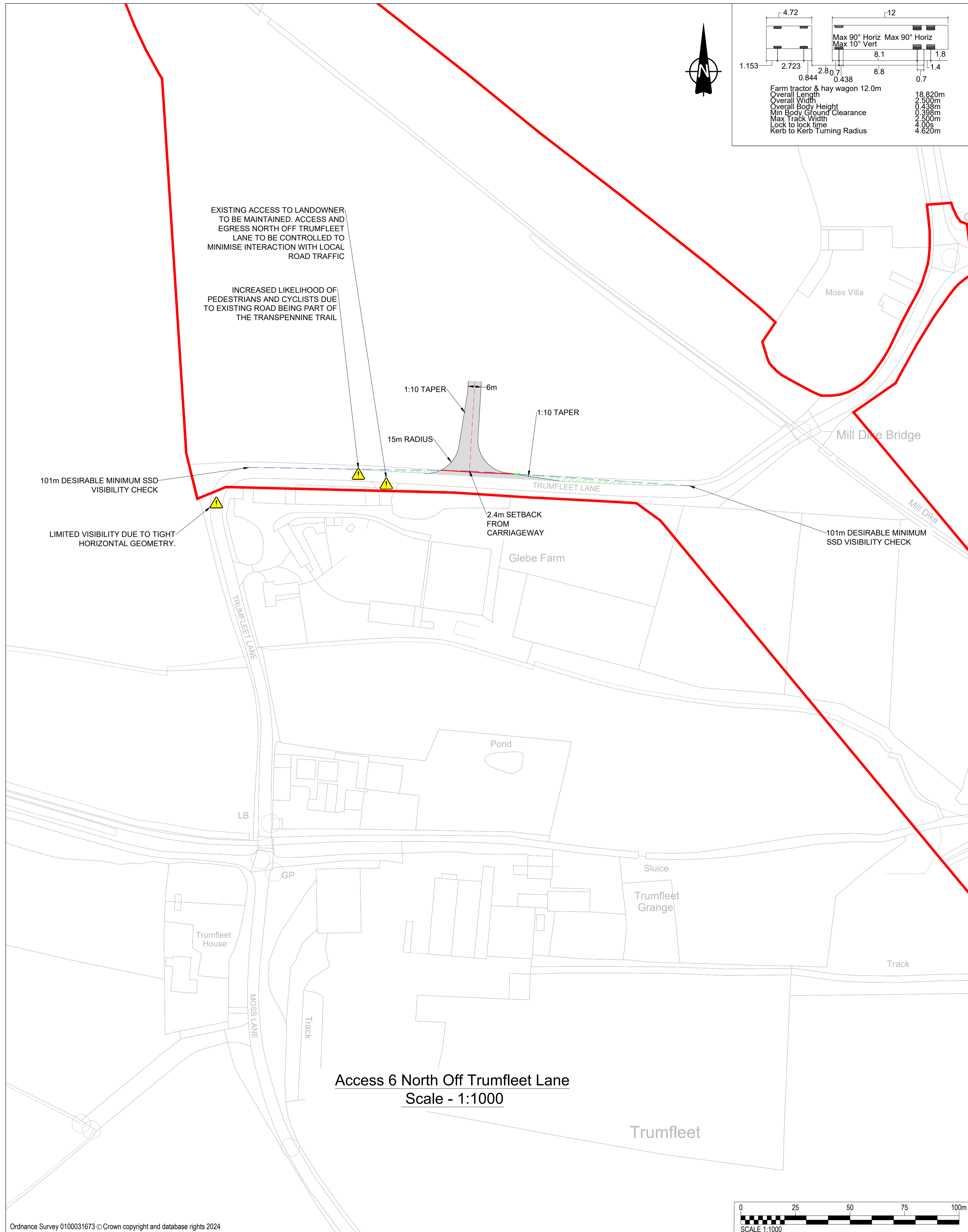

| | |
|--------------------------------|---------------|
| 4.72 | 12 |
| 1.153 | 2.723 |
| 0.844 | 2.807 |
| 0.438 | 8.8 |
| 0.7 | 1.4 |
| 1.8 | |
| 8.1 | |
| Max 90° Horiz | Max 90° Horiz |
| Max 10° Vert | Max 10° Vert |
| Farm tractor & hay wagon 12.0m | 18.820m |
| Overall Length | 2.500m |
| Overall Width | 0.438m |
| Overall Body Height | 0.398m |
| Min Body Ground Clearance | 2.500m |
| Max Track Width | 4.00s |
| Lock to lock time | 4.620m |
| Kerb to Kerb Turning Radius | |

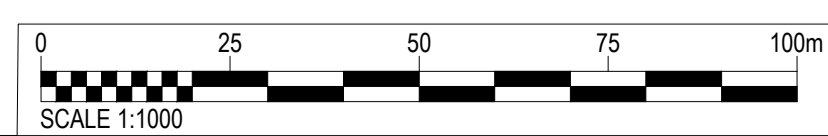

PROJECT

Fenwick Solar Farm

CLIENT

Fenwick Solar Project Limited

CONSULTANT

AECOM
 Saxon House, 27 Duke Street
 Chelmsford, Essex, CM1 1HT
 01245 771200 tel 01245 476121 fax
 www.aecom.com

GENERAL NOTES

1. This drawing is to be read in conjunction with all other relevant documentation.
2. Do not scale from this drawing, use only printed dimensions.
3. All dimensions in metres, all chainages, levels and coordinates are in meters unless defined otherwise.
4. This Drawing is to be read in conjunction with the project health & Safety File for any identified potential risks.
5. Vegetation to be removed denotes any vegetation features (such as hedgerows) that need to be removed to provide the required junction visibility. Any verge grassland is not to be removed but managed by the relevant maintainer to a low height so as to not impact upon junction visibility.
6. Junction visibility for the access is based upon visibility parameters derived using 85th percentile speed survey received on the 20th March 2024.

KEY

- Extent of Access Footprint
- Order limits
- Existing Public Rights of Way
- Vehicle body
- Vehicle body path
- Vehicle load
- Vehicle load path
- Vehicle wheels path
- Edge of road
- Land not included in the Order Limits
- Junction Visibility
- Vegetation Management for Vis splay
- Hedgerow Removal for Vis Splay
- Hedgerow Removal for Bellmouth Access

SHEET PLAN

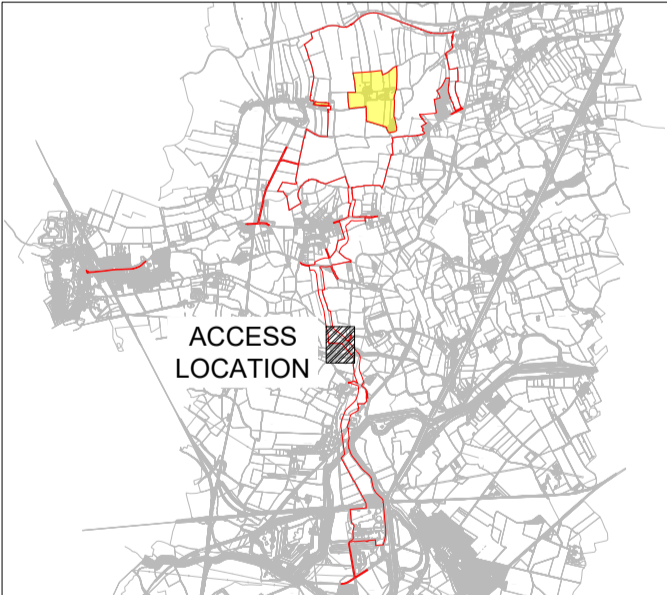

ISSUE/REVISION

| NO | DATE | DESCRIPTION |
|-----|------------|--------------------------|
| P03 | 04/12/2024 | Update for PINS Comments |
| P02 | 11/10/2024 | DCO Issue |
| P01 | 02/05/2024 | FIRST VERSION |
| I/R | DATE | DESCRIPTION |

PROJECT NUMBER

60698207

SHEET TITLE

ACCESS 6 NORTH OFF TRUMFLEET LANE LAYOUT AND SWEEP PATH ANALYSIS

SHEET NUMBER

60698207-ACM-HGN-00-DR-CE-1006

This drawing has been prepared for the use of AECOM's client. It may not be used, modified, reproduced or relied upon by third parties, except as agreed by AECOM or as required by law. AECOM accepts no responsibility, and denies any liability whatsoever, to any party that uses or relies on this drawing without AECOM's express written consent. Do not scale this document.

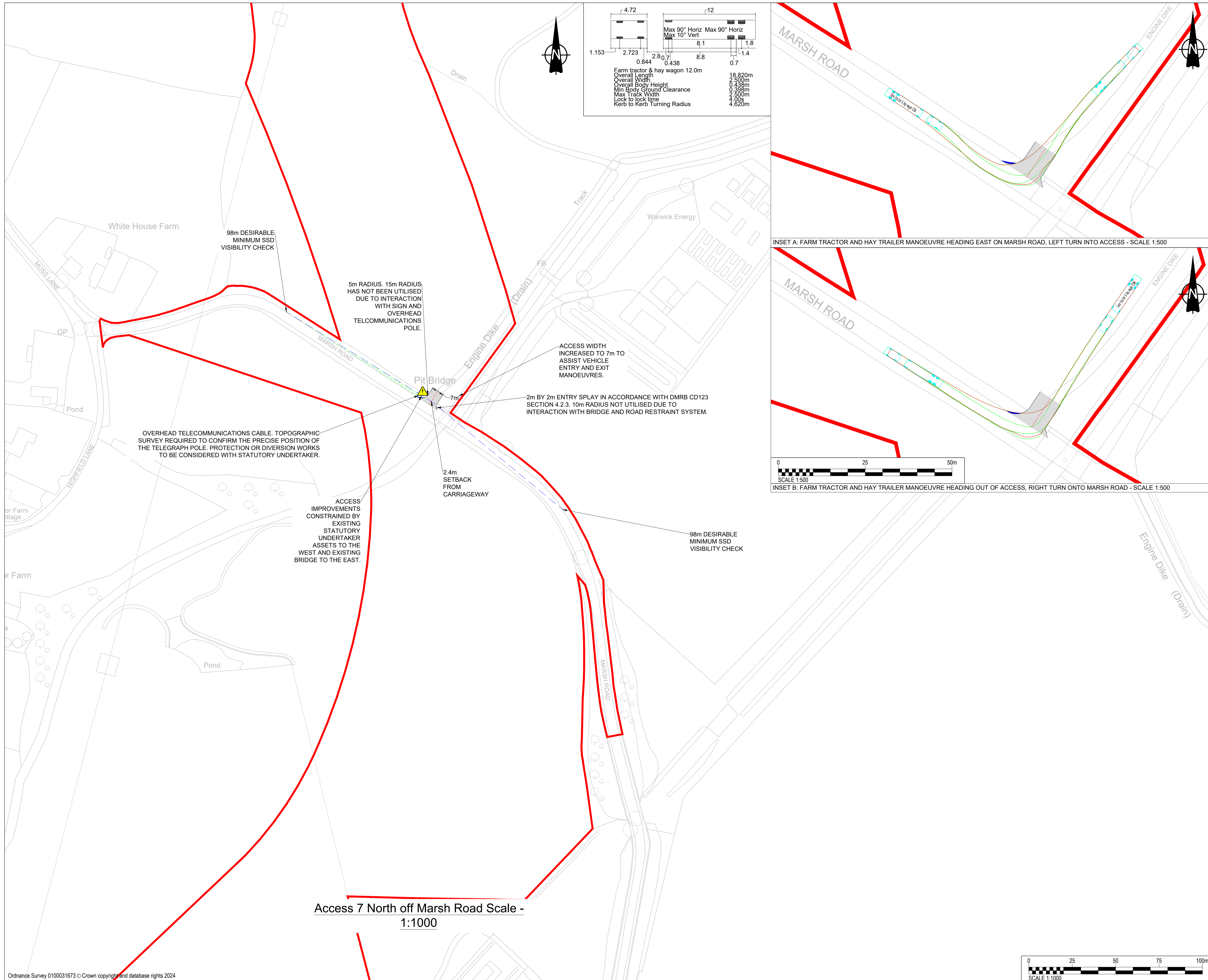

PROJECT

Fenwick Solar Farm

CLIENT

Fenwick Solar Project Limited

CONSULTANT

AECOM
 Saxon House, 27 Duke Street
 Chelmsford, Essex, CM1 1HT
 01245 771200 tel 01245 476121 fax
 www.aecom.com

GENERAL NOTES

- This drawing is to be read in conjunction with all other relevant documentation.
- Do not scale from this drawing, use only printed dimensions.
- All dimensions in meters, all chainages, levels and coordinates are in meters unless defined otherwise.
- This Drawing is to be read in conjunction with the project health & Safety File for any identified potential risks.
- Vegetation to be removed denotes any vegetation features (such as hedgerows) that need to be removed to provide the required junction visibility. Any verge grassland is not to be removed but managed by the relevant maintainer to a low height so as to not impact upon junction visibility.
- Junction visibility for the access is based upon visibility parameters derived using 85th percentile speed survey received on the 20th March 2024.

KEY

- Extent of Access Footprint
- Order limits
- Existing Public Rights of Way
- Vehicle body
- Vehicle body path
- Vehicle load
- Vehicle load path
- Vehicle wheels path
- Edge of road
- Land not included in the Order Limits
- Junction Visibility
- Vegetation Management for Vis splay
- Hedgerow Removal for Vis Splay
- Hedgerow Removal for Bellmouth Access
- Verge Protection Mats

SHEET PLAN

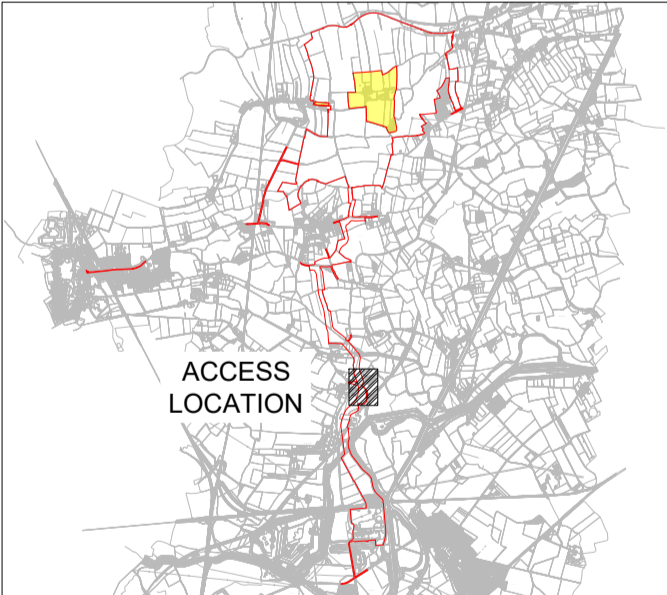

ISSUE/REVISION

| NO | DATE | DESCRIPTION |
|-----|------------|--------------------------|
| P03 | 04/12/2024 | Update for PINS Comments |
| P02 | 11/10/2024 | DCO Issue |
| P01 | 4/06/2024 | FIRST VERSION |
| I/R | DATE | DESCRIPTION |

PROJECT NUMBER

60698207

SHEET TITLE

ACCESS 7 NORTH OFF MARSH ROAD
 LANE LAYOUT AND SWEEP PATH
 ANALYSIS

SHEET NUMBER

60698207-ACM-HGN-00-DR-CE-1007

This drawing has been prepared for the use of AECOM's client. It may not be used, modified, reproduced or relied upon by third parties, except as agreed by AECOM or as required by law. AECOM accepts no responsibility, and denies any liability whatsoever, to any party that uses or relies on this drawing without AECOM's express written consent. Do not scale this document.

ISO A1 594mm x 841mm
 Checked: MEK Approved: JCH
 Designer: KP
 Project Management Initials:
 Last saved by: KYLE PLACKETT(2024-12-05) Last Plotted: 2024-12-05
 Filename: C:\USERS\KYLE PLACKETT\AECOM\60698207\FENWICK SOLAR FARM - GENERAL\900_CAD_GIS\910_CAD\HIGHWAYS TEAM\DRAWINGS (CAD)\60698207-ACM-HGN-00-DR-CE-1008.DWG

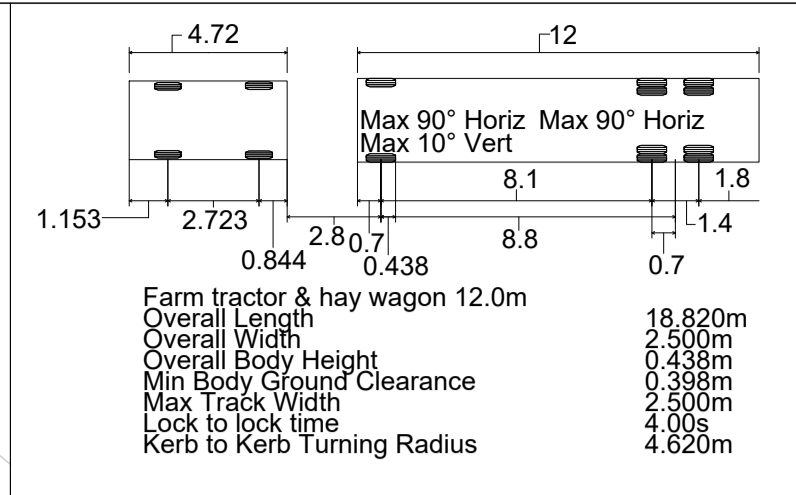
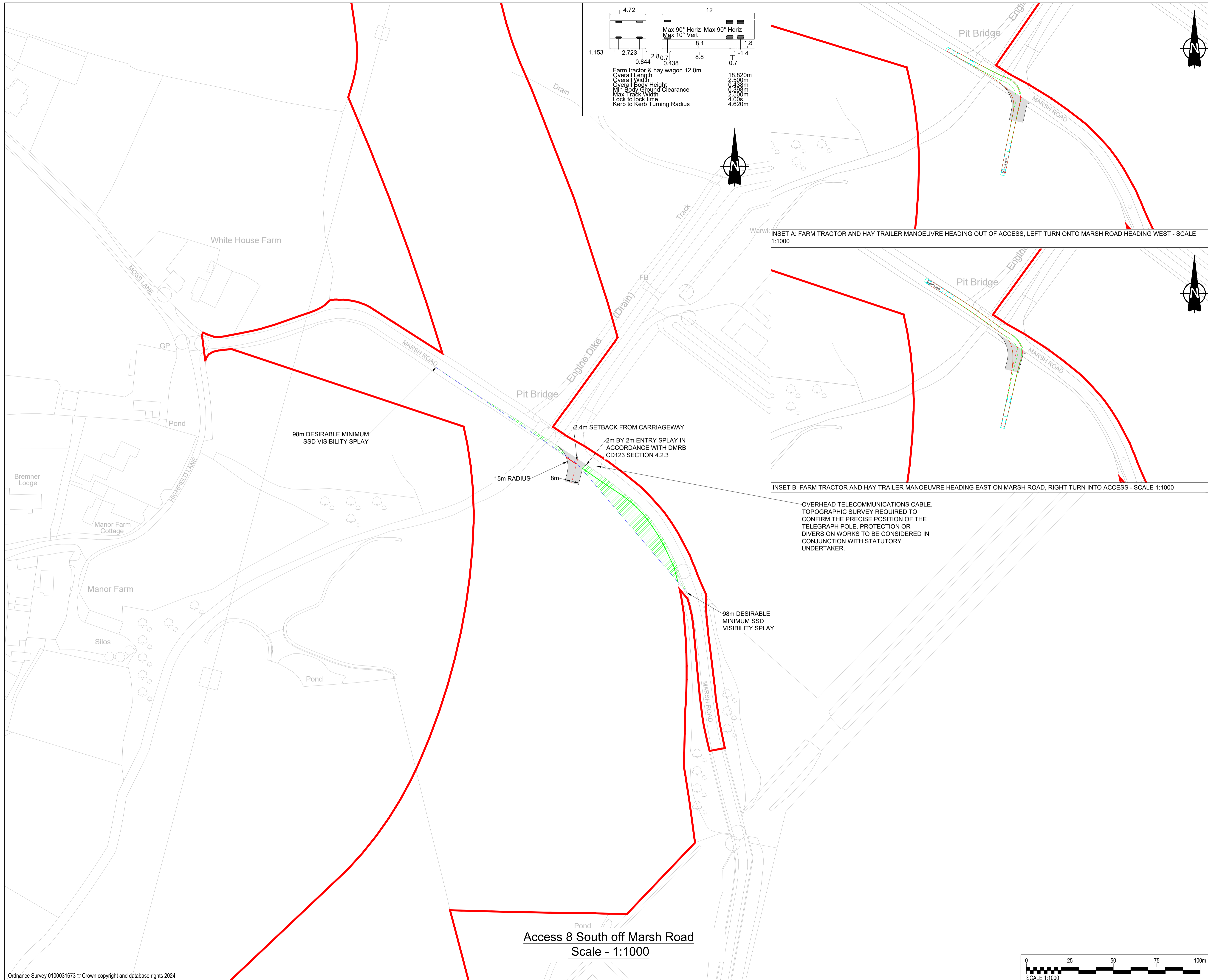

INSET A: FARM TRACTOR AND HAY TRAILER MANOEUVRE HEADING OUT OF ACCESS, LEFT TURN ONTO MARSH ROAD HEADING WEST - SCALE 1:1000

INSET B: FARM TRACTOR AND HAY TRAILER MANOEUVRE HEADING EAST ON MARSH ROAD, RIGHT TURN INTO ACCESS - SCALE 1:1000

OVERHEAD TELECOMMUNICATIONS CABLE. TOPOGRAPHIC SURVEY REQUIRED TO CONFIRM THE PRECISE POSITION OF THE TELEGRAPH POLE. PROTECTION OR DIVERSION WORKS TO BE CONSIDERED IN CONJUNCTION WITH STATUTORY UNDERTAKER.



PROJECT

Fenwick Solar Farm

CLIENT

Fenwick Solar Project Limited

CONSULTANT

AECOM
 Saxon House, 27 Duke Street
 Chelmsford, Essex, CM1 1HT
 01245 771200 tel 01245 476121 fax
 www.aecom.com

GENERAL NOTES

1. This drawing is to be read in conjunction with all other relevant documentation.
2. Do not scale from this drawing, use only printed dimensions.
3. All dimensions in meters, all chainages, levels and coordinates are in meters unless defined otherwise
4. This Drawing is to be read in conjunction with the project health & Safety File for any identified potential risks.
5. Vegetation to be removed denotes any vegetation features (such as hedgerows) that need to be removed to provide the required junction visibility. Any verge grassland is not to be removed but managed by the relevant maintainer to a low height so as to not impact upon junction visibility.
6. Junction visibility for the access is based upon visibility parameters derived using 85th percentile speed survey received on the 20th March 2024.

KEY

- Extent of Access Footprint
- Order limits
- Existing Public Rights of Way
- Vehicle body
- Vehicle body path
- Vehicle load
- Vehicle load path
- Vehicle wheels path
- Edge of road
- Land not included in the Order Limits
- Junction Visibility
- Vegetation Management for Vis splay
- Hedgerow Removal for Vis Splay
- Hedgerow Removal for Bellmouth Access

SHEET PLAN

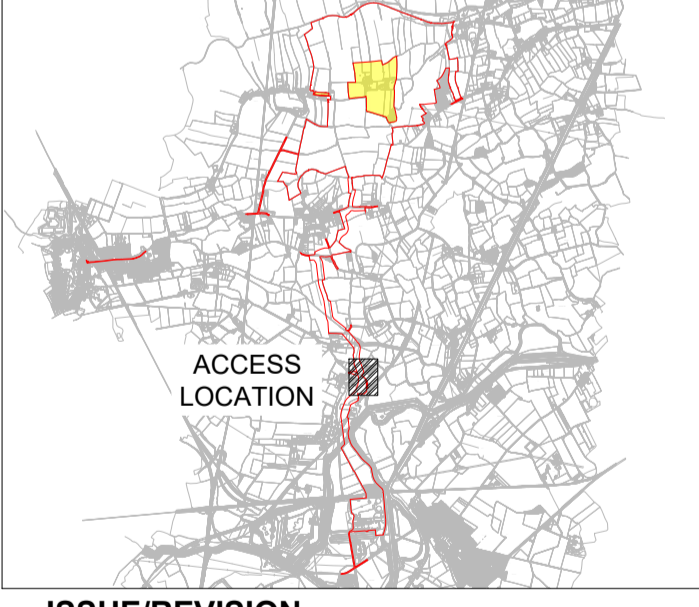

ISSUE/REVISION

| NO | DATE | DESCRIPTION |
|-----|------------|--------------------------|
| P03 | 04/12/2024 | Update for PINS Comments |
| P02 | 11/10/2024 | DCO Issue |
| P01 | 02/05/2024 | FIRST VERSION |
| I/R | DATE | DESCRIPTION |

PROJECT NUMBER

60698207

SHEET TITLE

ACCESS 8 SOUTH OFF MARSH ROAD LAYOUT AND SWEPT PATH ANALYSIS

SHEET NUMBER

60698207-ACM-HGN-00-DR-CE-1008

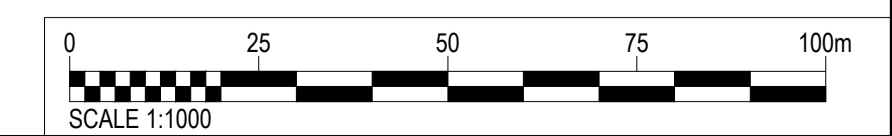

This drawing has been prepared for the use of AECOM's client. It may not be used, modified, reproduced or relied upon by third parties, except as agreed by AECOM or as required by law. AECOM accepts no responsibility, and denies any liability whatsoever, to any party that uses or relies on this drawing without AECOM's express written consent. Do not scale this document.

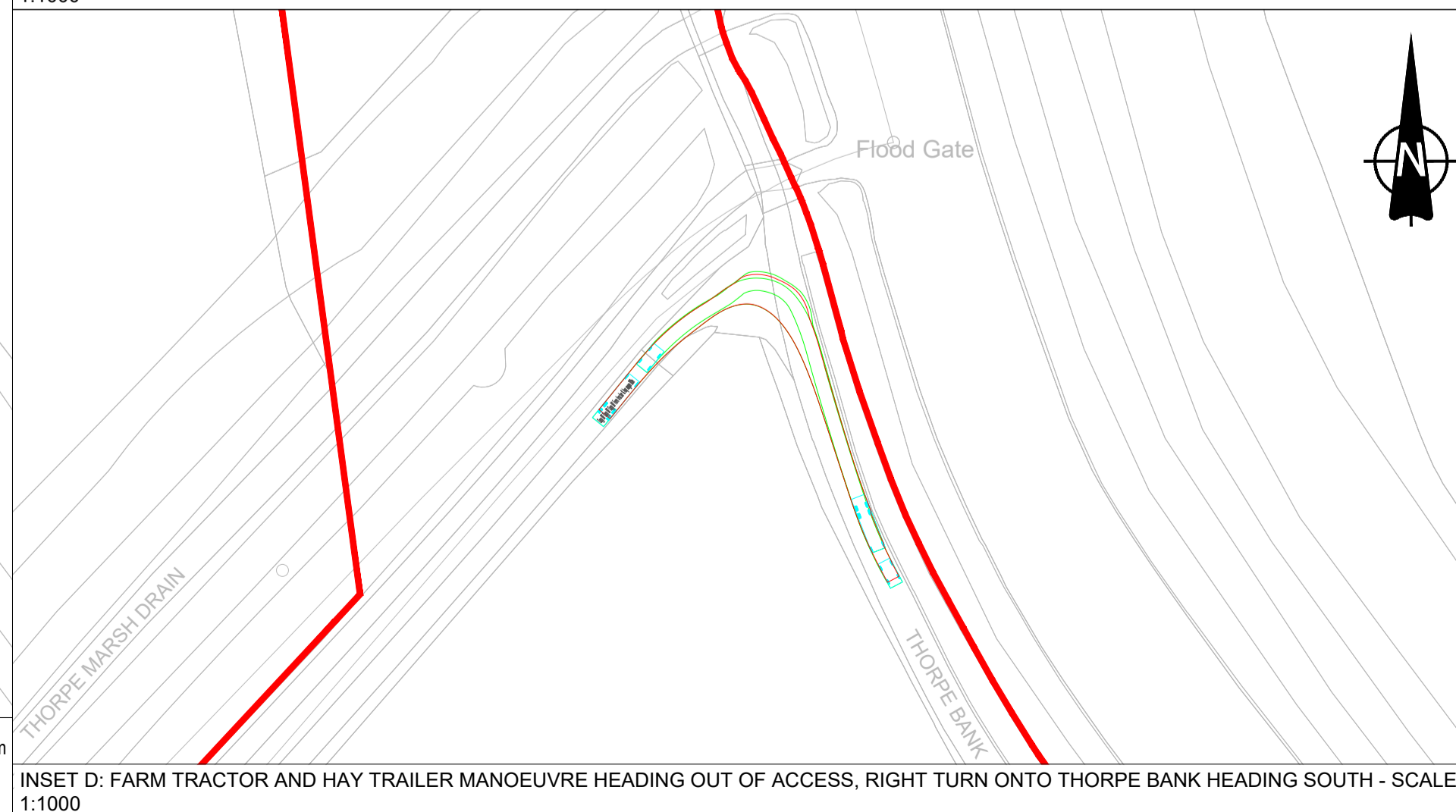
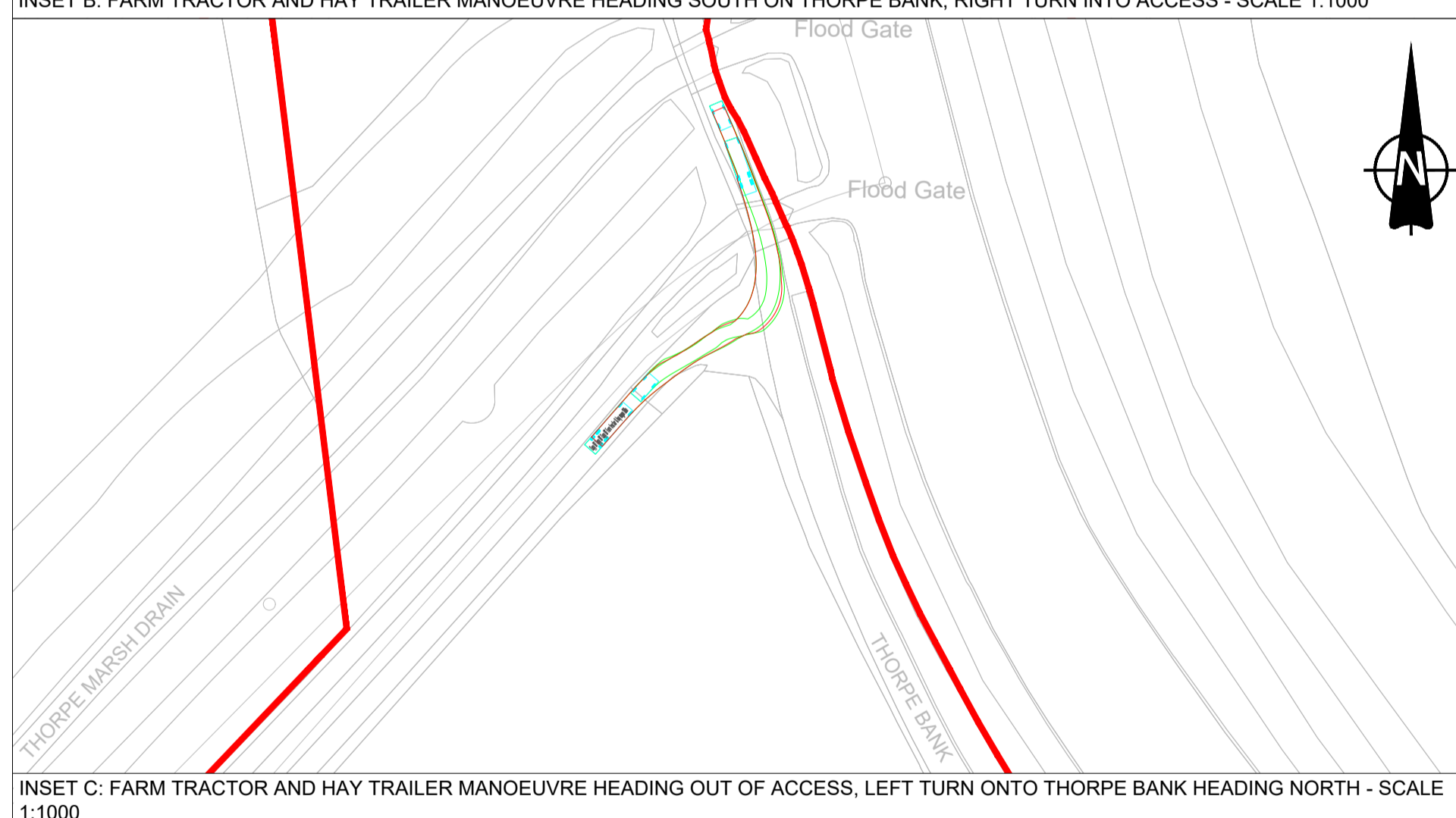
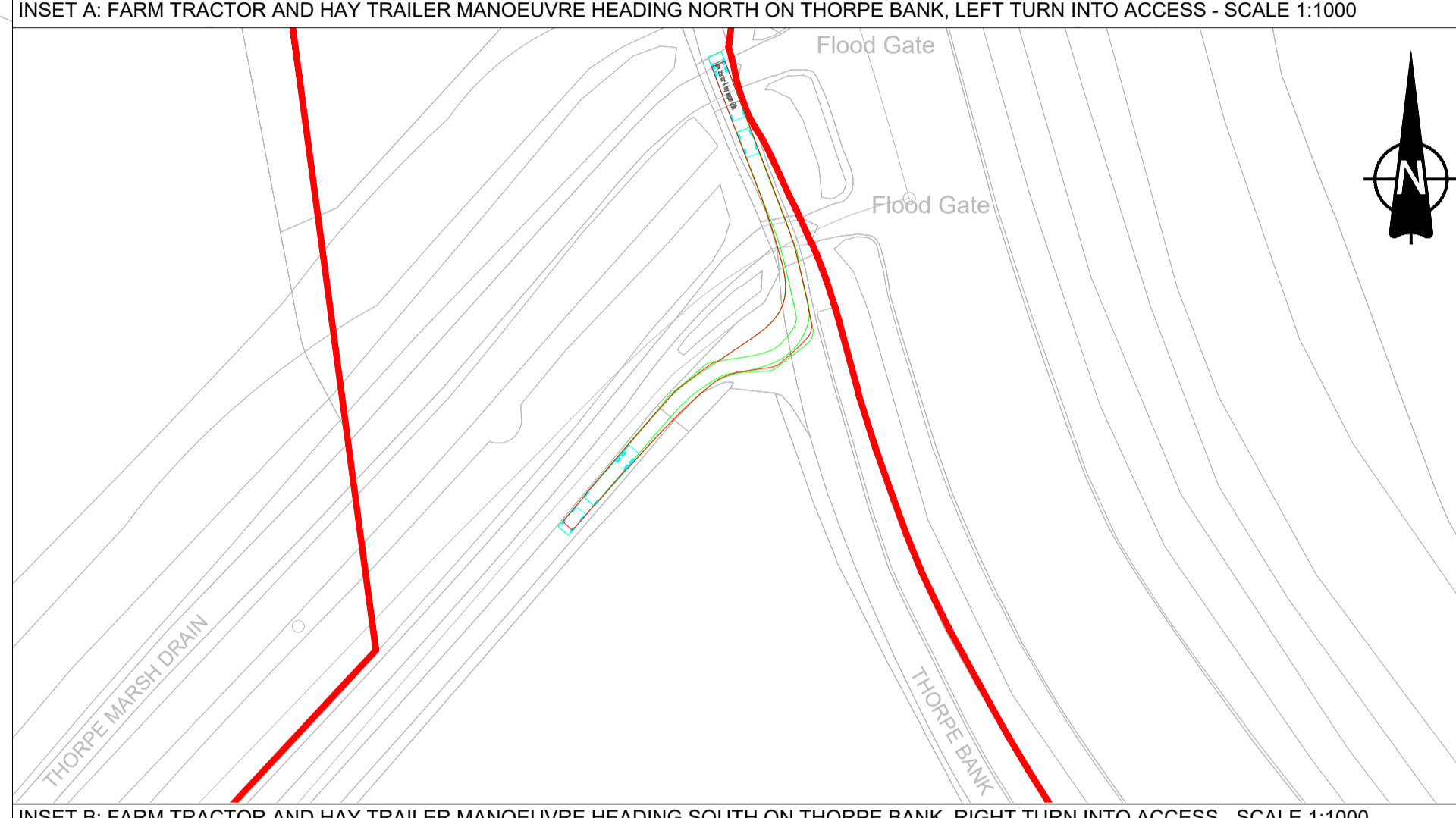
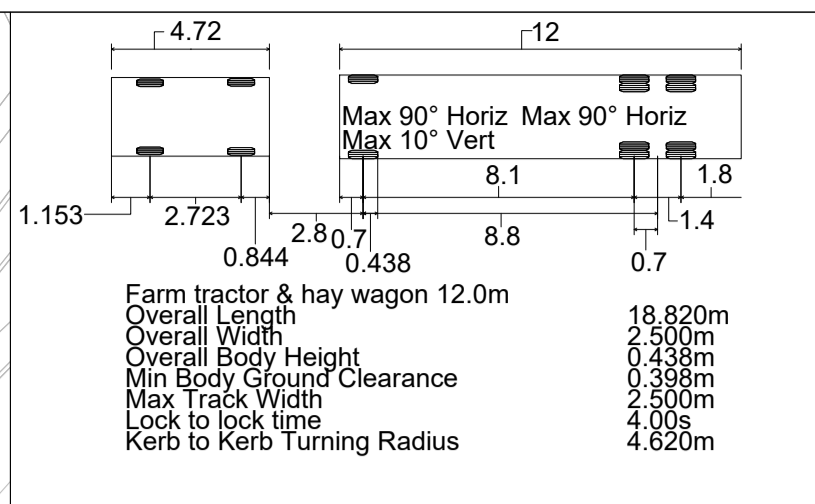
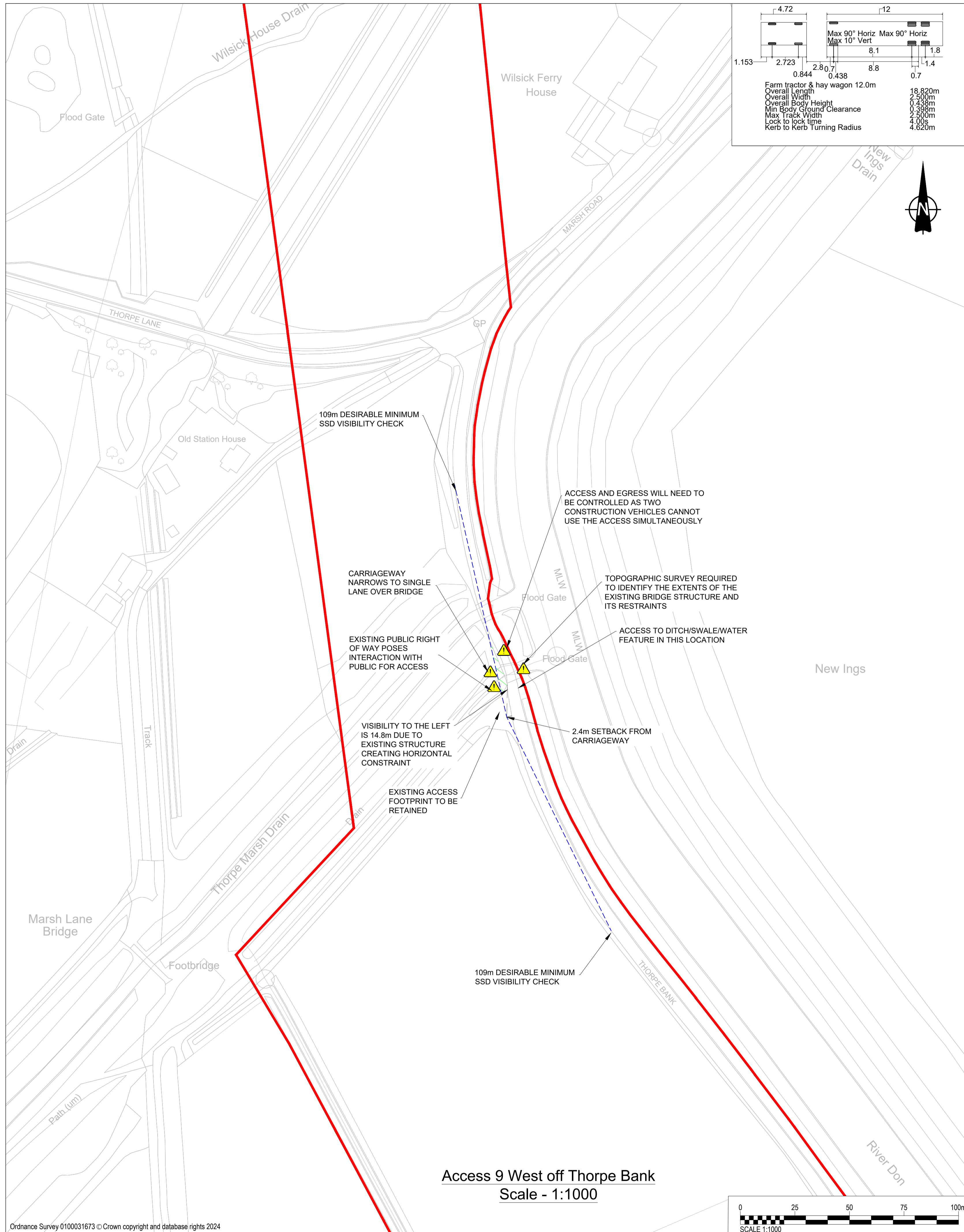

Access 9 West off Thorpe Bank
 Scale - 1:1000

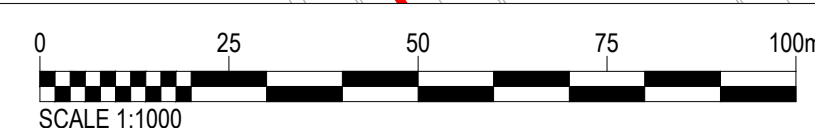

This drawing has been prepared for the use of AECOM's client. It may not be used, modified, reproduced or relied upon by third parties, except as agreed by AECOM or as required by law. AECOM accepts no responsibility, and denies any liability whatsoever, to any party that uses or relies on this drawing without AECOM's express written consent. Do not scale this document.



PROJECT

Fenwick Solar Farm

CLIENT

Fenwick Solar Project Limited

CONSULTANT

AECOM
 Saxon House, 27 Duke Street
 Chelmsford, Essex, CM1 1HT
 01245 771200 tel 01245 476121 fax
 www.aecom.com

GENERAL NOTES

1. This drawing is to be read in conjunction with all other relevant documentation. Do not scale from this drawing, use only printed dimensions.
2. All dimensions in meters, all chainages, levels and coordinates are in meters unless defined otherwise.
3. This Drawing is to be read in conjunction with the project health & Safety File for any identified potential risks.
4. Vegetation to be removed denotes any vegetation features (such as hedgerows) that need to be removed to provide the required junction visibility. Any verge grassland is not to be removed but managed by the relevant maintainer to a low height so as to not impact upon junction visibility.
5. Junction visibility for the access is based upon visibility parameters derived using 85th percentile speed survey received on the 20th March 2024.

KEY

- Extent of Access Footprint
- Order limits
- Existing Public Rights of Way
- Vehicle body
- Vehicle body path
- Vehicle load
- Vehicle load path
- Vehicle wheels path
- Edge of road
- Land not included in the Order Limits
- Junction Visibility
- Vegetation Management for Vis splay
- Hedgerow Removal for Vis Splay
- Hedgerow Removal for Bellmouth Access

SHEET PLAN

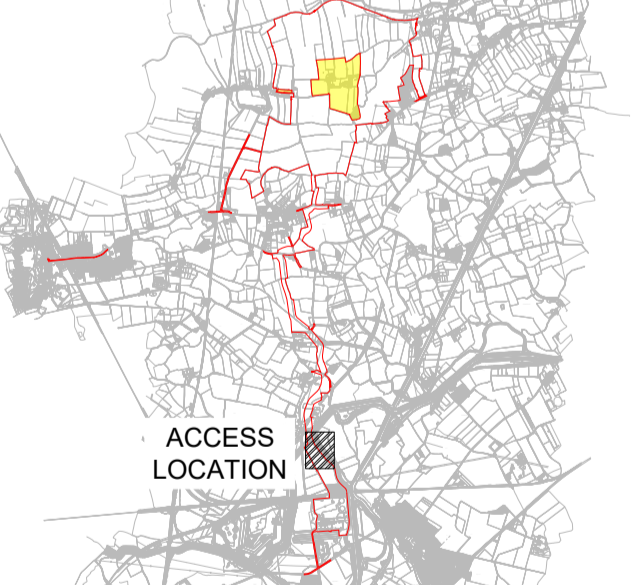

ISSUE/REVISION

| NO | DATE | DESCRIPTION |
|-----|------------|--------------------------|
| P03 | 04/12/2024 | Update for PINS Comments |
| P02 | 11/10/2024 | DCO Issue |
| P01 | 06/06/2024 | FIRST VERSION |
| I/R | DATE | DESCRIPTION |

PROJECT NUMBER

60698207

SHEET TITLE

ACCESS 9 WEST OFF THORPE BANK LAYOUT AND SWEEP PATH ANALYSIS

SHEET NUMBER

60698207-ACM-HGN-00-DR-CE-1009

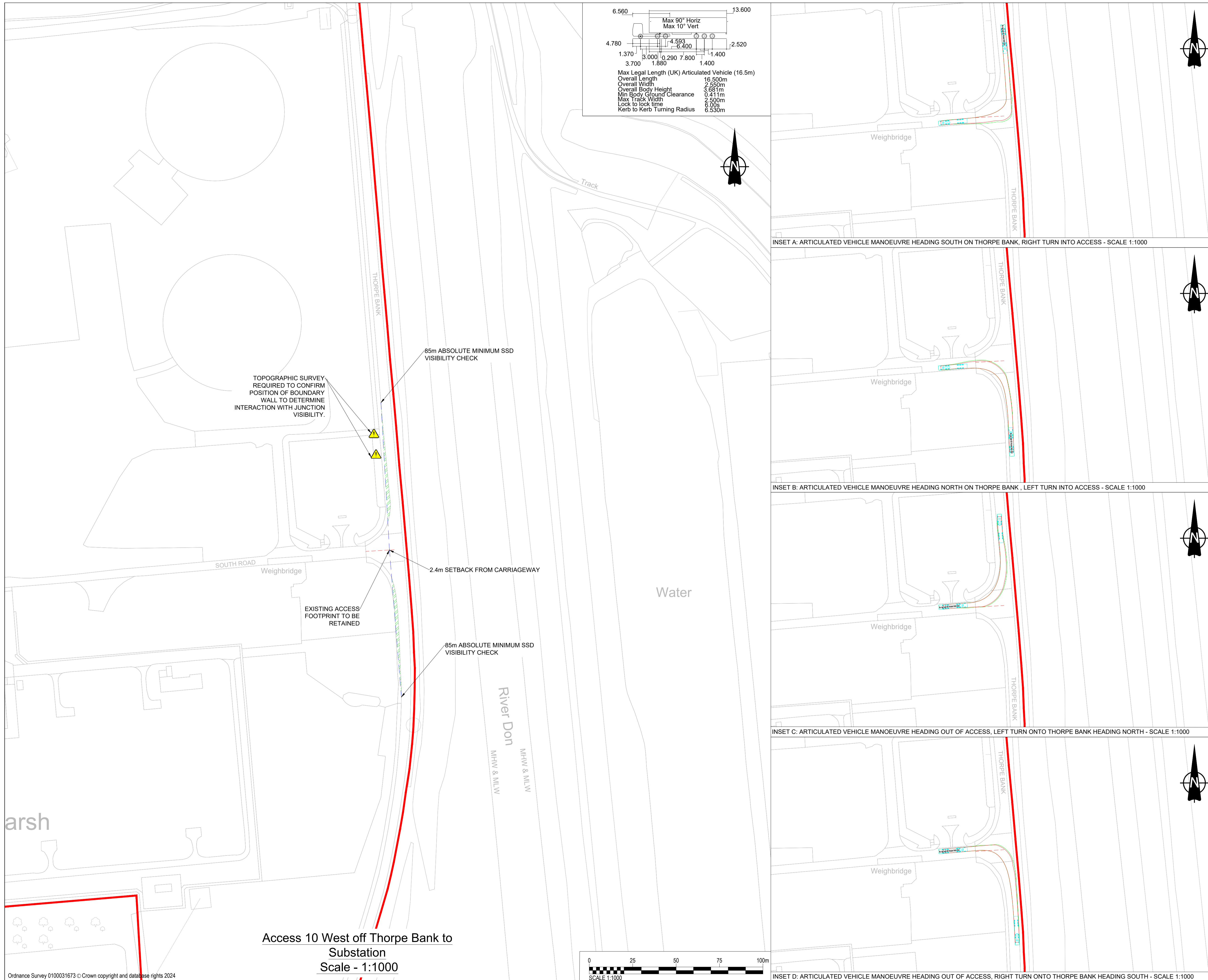

PROJECT

Fenwick Solar Farm

CLIENT

Fenwick Solar Project Limited

CONSULTANT

AECOM
 Saxon House, 27 Duke Street
 Chelmsford, Essex, CM1 1HT
 01245 771200 tel 01245 476121 fax
 www.aecom.com

GENERAL NOTES

1. This drawing is to be read in conjunction with all other relevant documentation.
2. Do not scale from this drawing, use only printed dimensions.
3. All dimensions in meters, all chainages, levels and coordinates are in meters unless defined otherwise
4. This Drawing is to be read in conjunction with the project health & Safety File for any identified potential risks.
5. Vegetation to be removed denotes any vegetation features (such as hedgerows) that need to be removed to provide the required junction visibility. Any verge grassland is not to be removed but managed by the relevant maintainer to a low height so as to not impact upon junction visibility.
6. Junction visibility for the access is based upon visibility parameters derived using 85th percentile speed survey received on the 20th March 2024.

KEY

- Extent of Access Footprint
- Order limits
- Existing Public Rights of Way
- Vehicle body
- Vehicle body path
- Vehicle load
- Vehicle load path
- Vehicle wheels path
- Edge of road
- Land not included in the Order Limits
- Junction Visibility
- Vegetation Management for Vis splay
- Hedgerow Removal for Vis Splay
- Hedgerow Removal for Bellmouth Access

SHEET PLAN

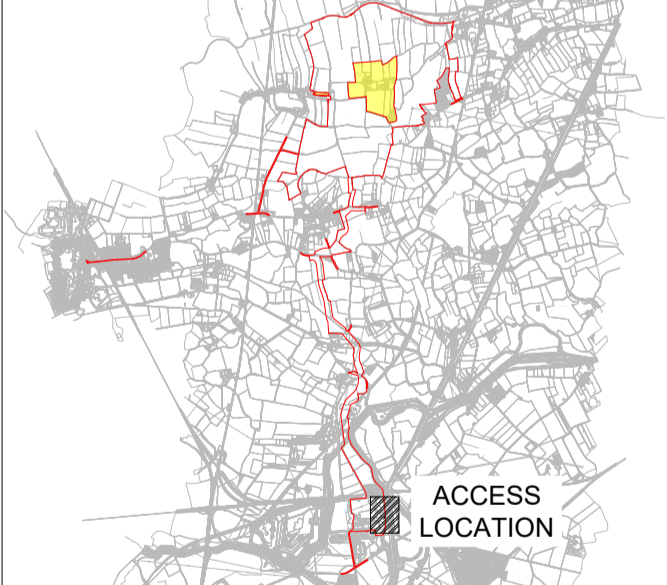

ISSUE/REVISION

| NO | DATE | DESCRIPTION |
|-----|------------|--------------------------|
| P03 | 04/12/2024 | Update for PINS Comments |
| P02 | 11/10/2024 | DCO Issue |
| P01 | 02/05/2024 | FIRST VERSION |
| I/R | DATE | DESCRIPTION |

PROJECT NUMBER

60698207

SHEET TITLE

ACCESS 10 WEST OFF THORPE BANK TO SUBSTATION LAYOUT AND SWEPT PATH ANALYSIS

SHEET NUMBER

60698207-ACM-HGN-00-DR-CE-1010

Access 10 West off Thorpe Bank to Substation
 Scale - 1:1000

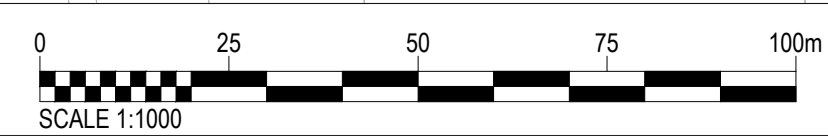

This drawing has been prepared for the use of AECOM's client. It may not be used, modified, reproduced or relied upon by third parties, except as agreed by AECOM or as required by law. AECOM accepts no responsibility, and denies any liability whatsoever, to any party that uses or relies on this drawing without AECOM's express written consent. Do not scale this document.

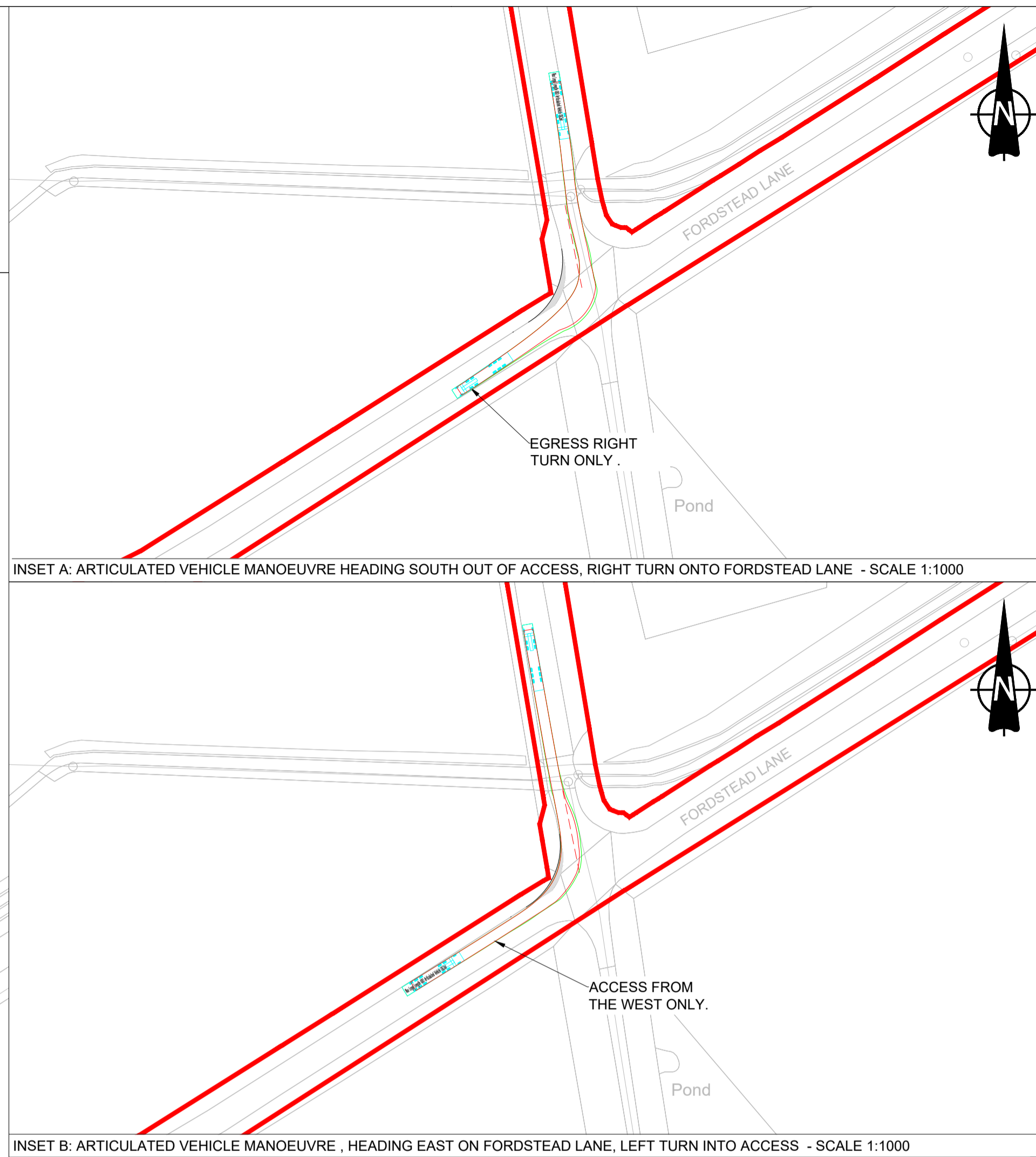
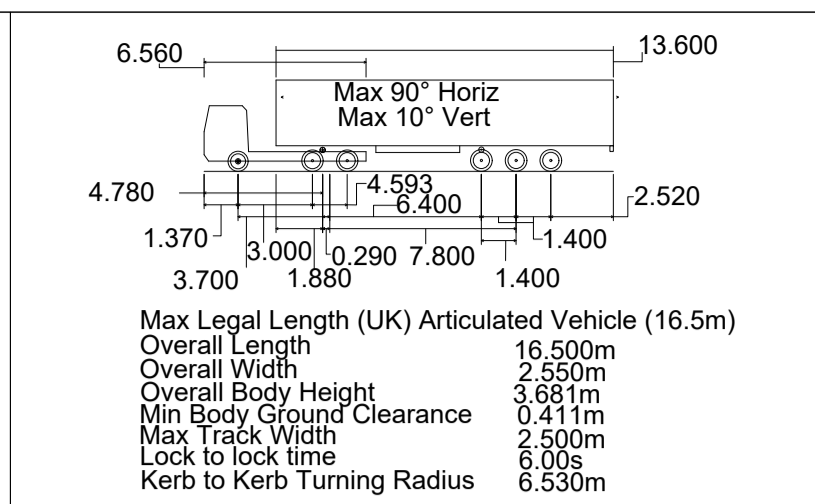
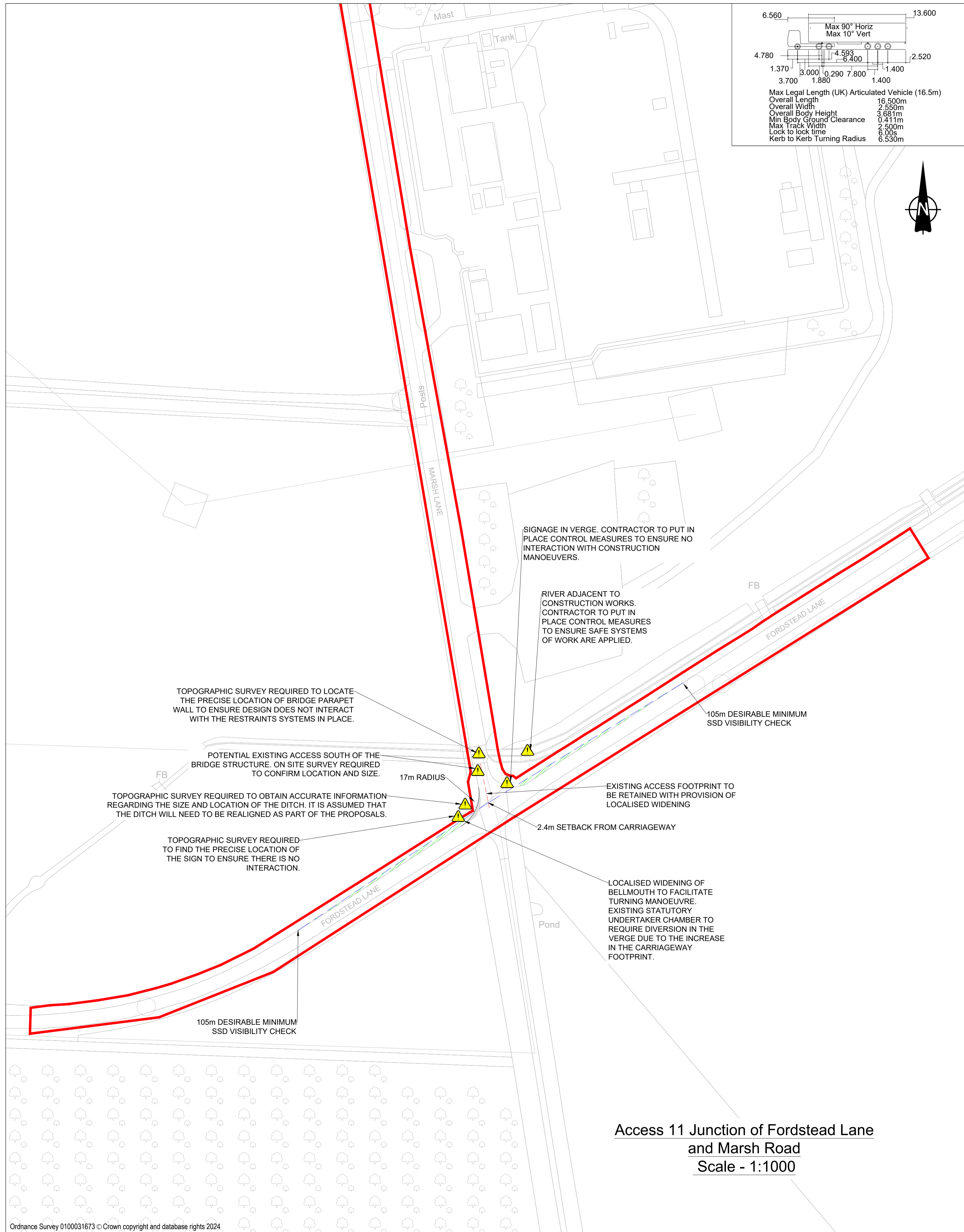

PROJECT

Fenwick Solar Farm

CLIENT

Fenwick Solar Project Limited

CONSULTANT

AECOM
Saxon House, 27 Duke Street
Chelmsford, Essex, CM1 1HT
01245 771200 tel 01245 476121 fax
www.aecom.com

GENERAL NOTES

- This drawing is to be read in conjunction with all other relevant documentation.
- Do not scale from this drawing, use only printed dimensions.
- All dimensions in meters, all chainages, levels and coordinates are in meters unless defined otherwise.
- This Drawing is to be read in conjunction with the project health & Safety File for any identified potential risks.
- Vegetation to be removed denotes any vegetation features (such as hedgerows) that need to be removed to provide the required junction visibility. Any verge grassland is not to be removed but managed by the relevant maintainer to a low height so as to not impact upon junction visibility.
- Junction visibility for the access is based upon visibility parameters derived using 85th percentile speed survey received on the 20th March 2024.

KEY

- Extent of Access Footprint
- Order limits
- Existing Public Rights of Way
- Vehicle body
- Vehicle body path
- Vehicle load
- Vehicle load path
- Vehicle wheels path
- Edge of road
- Land not included in the Order Limits
- Junction Visibility
- Vegetation Management for Vis splay
- Hedgerow Removal for Vis Splay
- Hedgerow Removal for Bellmouth Access

SHEET PLAN

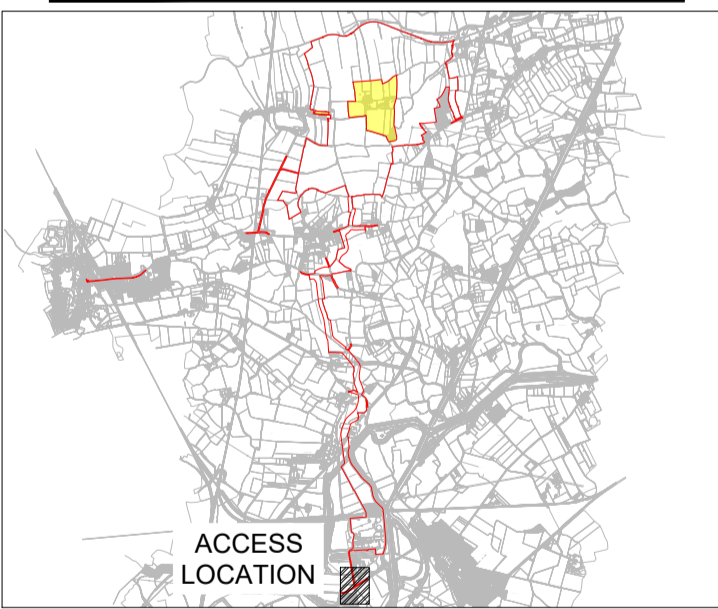

ISSUE/REVISION

| NO | DATE | DESCRIPTION |
|-----|------------|--------------------------|
| P03 | 04/12/2024 | Update for PINS Comments |
| P02 | 11/10/2024 | DCO Issue |
| P01 | 02/05/2024 | FIRST VERSION |
| I/R | DATE | DESCRIPTION |

PROJECT NUMBER

60698207

SHEET TITLE

ACCESS 11 JUNCTION OF FORDSTEAD LANE AND MARSH ROAD LAYOUT AND SWEEP PATH ANALYSIS

SHEET NUMBER

60698207-ACM-HGN-00-DR-CE-1011

**Access 11 Junction of Fordstead Lane and Marsh Road
Scale - 1:1000**

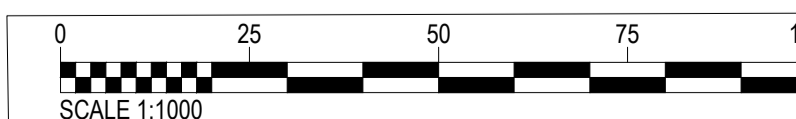

This drawing has been prepared for the use of AECOM's client. It may not be used, modified, reproduced or relied upon by third parties, except as agreed by AECOM or as required by law. AECOM accepts no responsibility, and denies any liability whatsoever, to any party that uses or relies on this drawing without AECOM's express written consent. Do not scale this document.

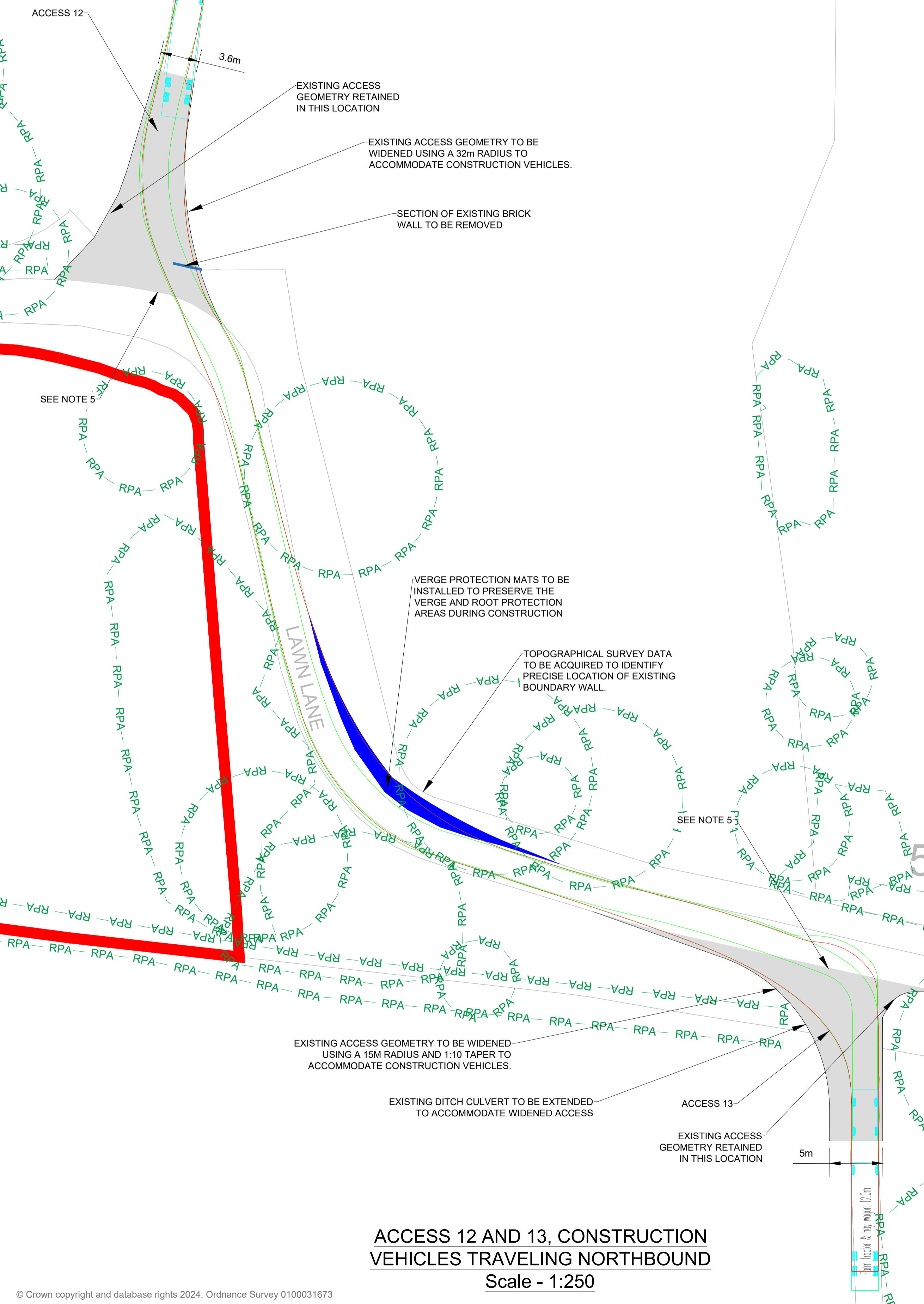
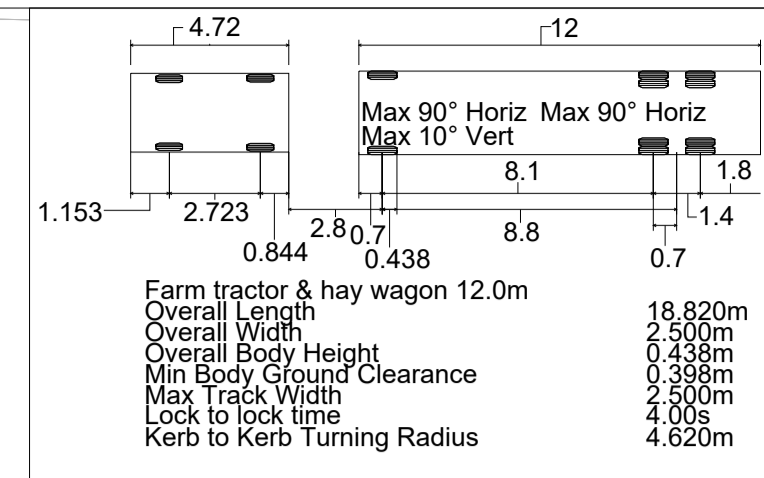
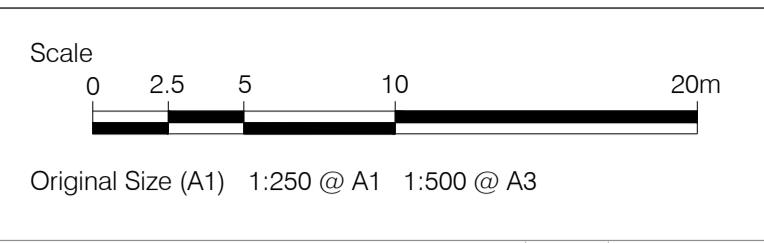

ACCESS 12 AND 13, CONSTRUCTION VEHICLES TRAVELING NORTHBOUND
Scale - 1:250

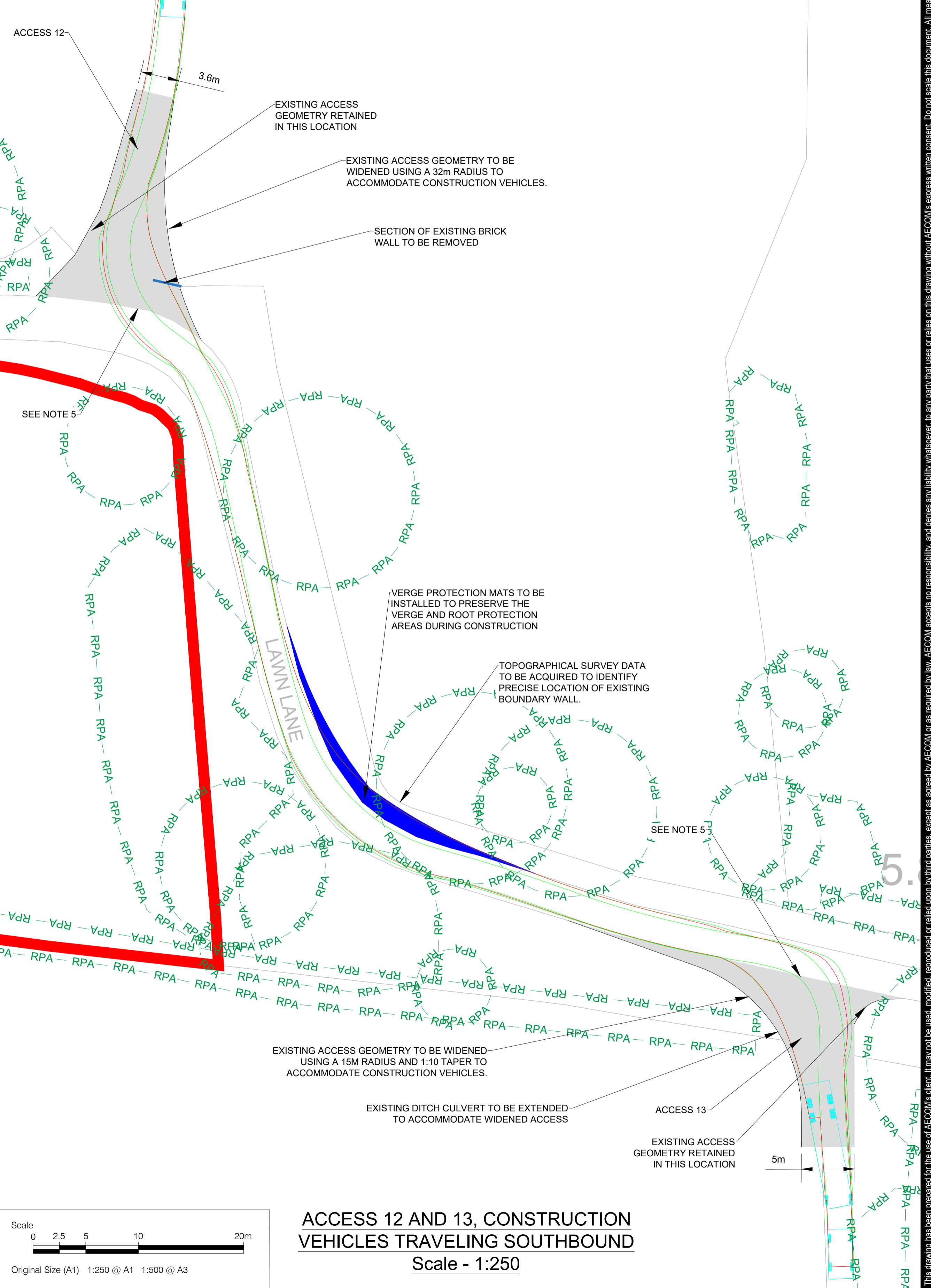
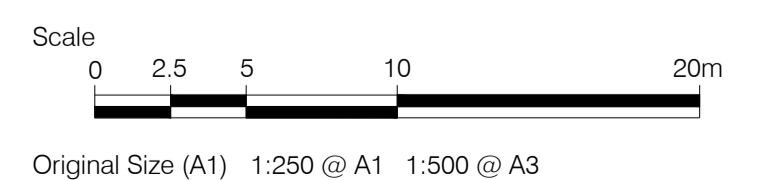

ACCESS 12 AND 13, CONSTRUCTION VEHICLES TRAVELING SOUTHBOUND
Scale - 1:250

- CONSULTANT**
1. This drawing is to be read in conjunction with all other relevant documentation.
 2. Do not scale from this drawing, use only printed dimensions.
 3. All dimensions in meters, all chainages, levels and coordinates are in meters unless defined otherwise.
 4. This Drawing is to be read in conjunction with the project health & Safety File for any identified potential risks.
 5. Access and egress for construction vehicles between access 12 and 13 to be controlled by traffic management measures to ensure access and egress movements do not interact with limited local traffic movements on Lawn Lane east of Fenwick.

KEY

- Extent of Access Footprint
- Order Limits
- Existing Public Rights of Way
- Vehicle body
- Vehicle body path
- Vehicle load
- Vehicle load path
- Vehicle wheels path
- Edge of road
- Land not included in the Order Limits
- Wall Removal for Bellmouth Access
- Root protection area
- Verge protection mats

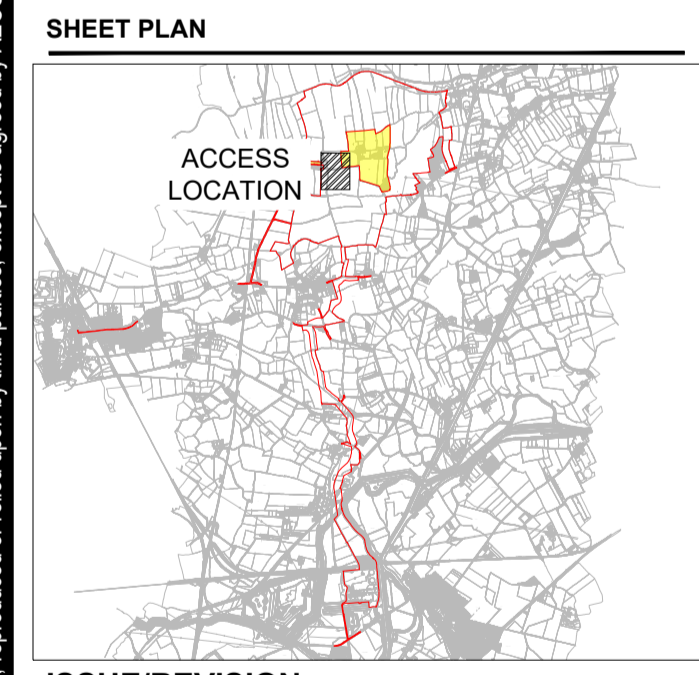

ISSUE/REVISION

| NO | DATE | DESCRIPTION |
|-----|------------|--------------------------|
| P02 | 04/12/2024 | Update for PINS Comments |
| P01 | 27/09/2024 | FIRST VERSION |
| I/R | DATE | DESCRIPTION |

PROJECT NUMBER
60698207

SHEET TITLE
ACCESS 12 & 13 OFF OF LAWN LANE LAYOUT AND SWEEP PATH ANALYSIS

SHEET NUMBER
60698207-ACM-HGN-00-DR-CE-1012

This drawing has been prepared for the use of AECOM's client. It may not be used, modified, reproduced or relied upon by third parties, except as agreed by AECOM or as required by law. AECOM accepts no responsibility, and denies any liability whatsoever, to any party that uses or relies on this drawing without AECOM's express written consent. Do not scale this document. All measurements must be obtained from the stated dimensions.

An aerial photograph of a vast solar farm at sunset. The rows of solar panels stretch across the landscape, creating a strong sense of perspective. The sky is a deep orange and red, with the sun low on the horizon, casting long shadows and highlighting the texture of the panels.

BOOM
POWER

BUILD | OWN | OPERATE | MAINTAIN

BOOM-POWER.CO.UK